

NCO developed a range of timber doors for a variety of applications. These doors are being installed to effectively control noise and fire-resisting in conference rooms, broadcasting studios, theatres and music practice rooms.

Acoustic doors, tested in the accredited laboratory, equipped with compression seals around the periphery of the doors.

Fire doors are tested to BS476- Part 22:1987 with fire rating up to two hours for stability and integrity. An intumescent strip is used for fire rating doors.

The following figures present the results for various doors:

**ACOUSTIC DOOR PERFORMANCE**

Model	Weighted Apparent SRI R'w (ISO-140-3)	Sound Transmission Loss (STC), dB (ASTM-E90)	Noise Insulation Class (NIC), dB (ASTM-E336)
37dB-TA	37	37	42
39dB-TA	39	39	42
40dB / 41dB-TA	40 / 41	40	43
42dB-TA	42	40	42
43dB-TA	43	43	46
44dB-TA	44	44	46
45dB-TA	45	46	49
46dB-TA	46	46	46
49dB-TA	49	50	50

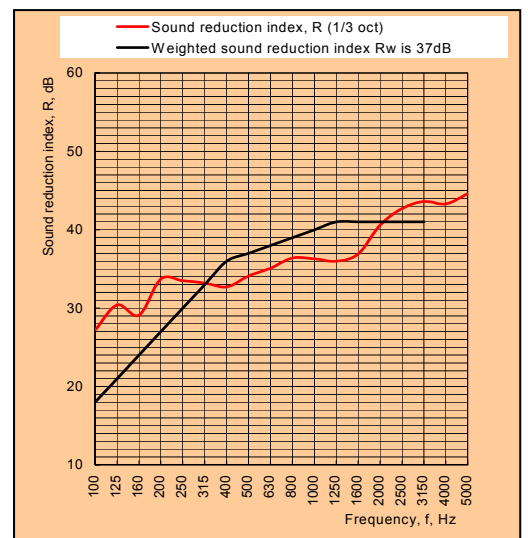

**FIRE DOOR PERFORMANCE**

Fire Code: (To BS 476: Part 22:1987)

Model	Stability	Integrity	Insulation
F60	60 minutes	60 minutes	-
F120/F120A*	120 minutes	120 minutes	30 minutes*

**GENERAL PURPOSE DOOR**

(Non-Acoustic, Non-Fire rated)

Model	Core/ Thickness	FSTC (Estimated)
GP44-H	Hollow/ 44mm	< 20 dB
GP50-H	Hollow/ 50mm	<20 dB
GP44-S	Solid/ 44mm	20 – 25 dB
GP50-S	Solid/ 50mm	20 – 25 dB

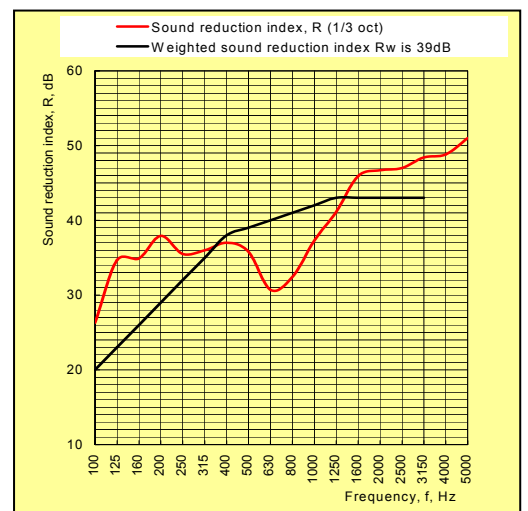

**DOOR TYPE**

Door Type	General Purpose	Acoustic	Fire-resisting	Acoustic & Fire
BASIC MODEL	GP44 GP50	37dB-TA / 39dB-TA 40dB-TA / 41dB-TA 42dB-TA / 43dB-TA 44dB-TA / 45dB-TA 46dB-TA / 50dB-TA	F60 F120 F120A	37dB / 39dB -TAF 41dB / 42dB - TAF 43dB / 45dB-TAF 46dB-TAF

**DOOR SPECIFICATION**

Door Type	General Purpose	Acoustic	Fire-resisting	Acoustic & Fire
DOOR LEAF	GP44: Hollow Core GP50: Solid Core	Supplied hung in frame	F60: Solid Core F120: Solid Core F120A: Solid Core	Supplied hung in frame
DOOR FRAME a) Softwood b) Hardwood c) Steel	Standard Available	Standard Standard (>40dB)	F60: Standard F60: Available F120: Standard	Standard Standard (>40dB)
COMPRESSION SEALS	Available	Standard	Not available	Standard
INTUMESCENT STRIP	Not available	Not available	Standard	Standard
DOOR CLOSER	Available	Available	Available	Available
DOOR LOCK	Available	Available	Available	Available
VISION PANEL	Available	Available	Available	Available

**DOOR FINISH**

Door Type	General Purpose	Acoustic	Fire-resisting	Acoustic & Fire
PRIMER PAINT	Standard	Standard	Standard	Standard
VENEER	Standard	Standard	Standard	Standard
PLASTIC LAMINATE	Available	Available	Available	Available

**RANGE OF VENEER**

Door Type	General Purpose	Acoustic	Fire-resisting	Acoustic & Fire
BEECH	Standard	Standard	Standard	Standard
CHERRY	Available	Available	Available	Available
MAPLE	Available	Available	Available	Available
TEAK	Available	Available	Available	Available
C.O.M.	Available	Available	Available	Available

Note: Please consult NCO for special finishes.

**DIMENSIONS (STRUCTURE WALL OPENING, MM)**

<b>Door Type</b>	<b>37dB / 39*dB / F60</b>				<b>39dB/40dB/41dB/42dB/43dB/44dB/45dB / 46dB / 49dB / F120 / F120A</b>			
<b>Leave</b>	<b>Single</b>		<b>Double</b>		<b>Single</b>		<b>Double</b>	
	<b>W</b>	<b>H</b>	<b>W</b>	<b>H</b>	<b>W</b>	<b>H</b>	<b>W</b>	<b>H</b>
Standard Size	915	2125	1830	2125	915	2125	1830	2125
Fire Door Size (Max.)	1080	2190	2045	2190	1049	2392	2384	2452

Note: overall frame size is 10mm less than Structural Work Opening for width and height.

**DIMENSIONS (CLEAR DOOR OPENING = STRUCTURE WALL OPENING - VALUES BELOW)**

<b>Leave</b>	<b>Single</b>		<b>Double</b>	
<b>Door Type</b>	<b>W,mm</b>	<b>H,mm</b>	<b>W,mm</b>	<b>H,mm</b>
GP44 / GP54	110	55	110	55
F60 / F120 / F120*	130	60	130	60
37dB-TAF / (39*dB-TA)	230 / (330)	120 / (170)	230 / (330)	120 / (170)
39/43dB-TAF	150	70	150	70
40/44dB-TA	220	110	220	110
41/42/45*/46dB-TAF	150	80	150	80
45dB-TA / 49dB-TA	210	120	210	120

Note: These dimensions may be subject to change. Please confirm with Techwide.

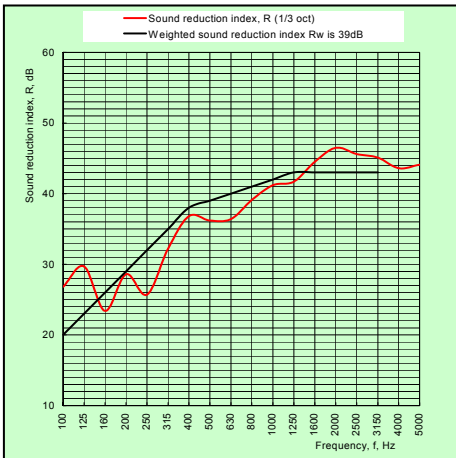

Model: 39dB (STC 39)

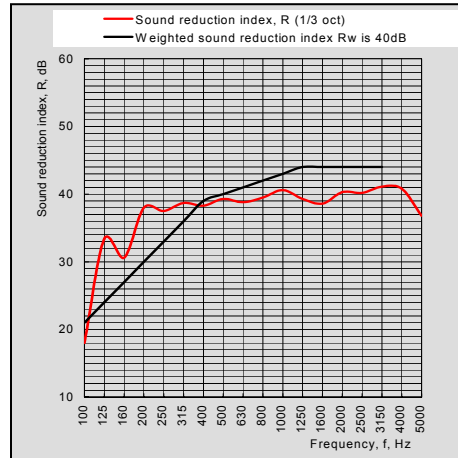

Model: 40dB (STC 40)

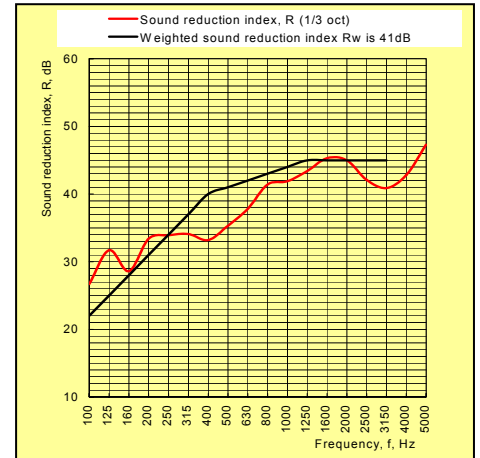

Model: 41dB (STC 40)

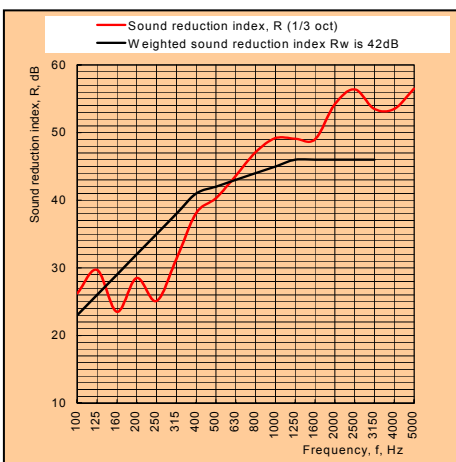

Model: 42dB (STC 40)

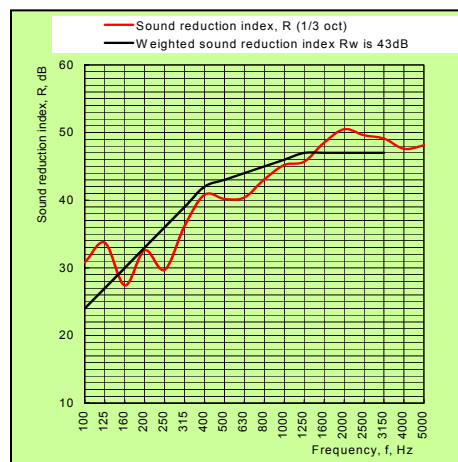

Model: 43dB (STC 43)

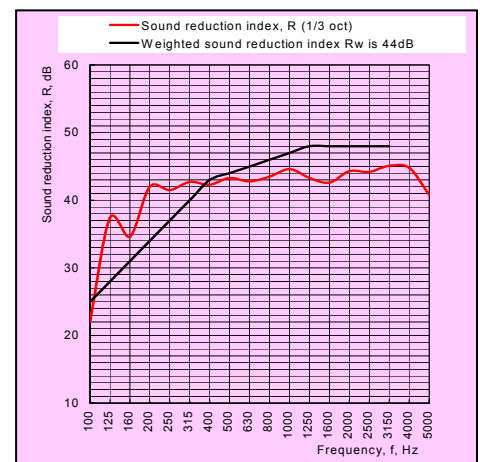

Model: 44dB (STC 44)

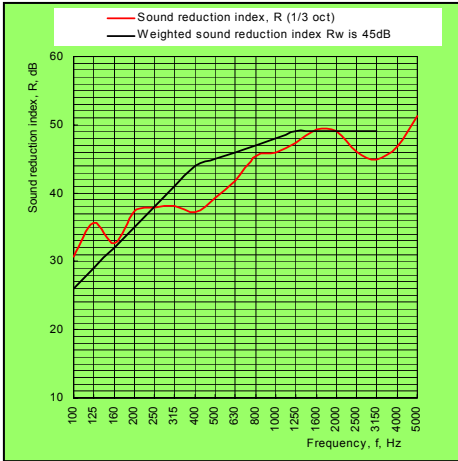

Model: 45\*dB (STC 44)

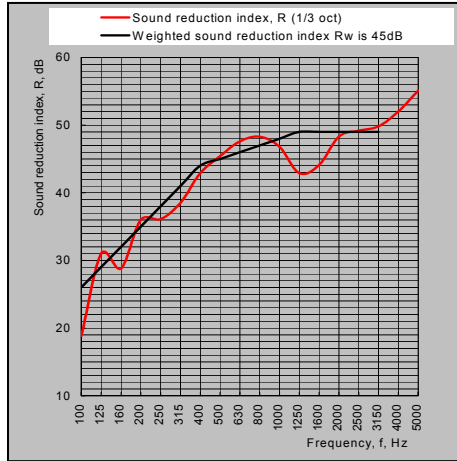

Model: 45dB (STC 46)

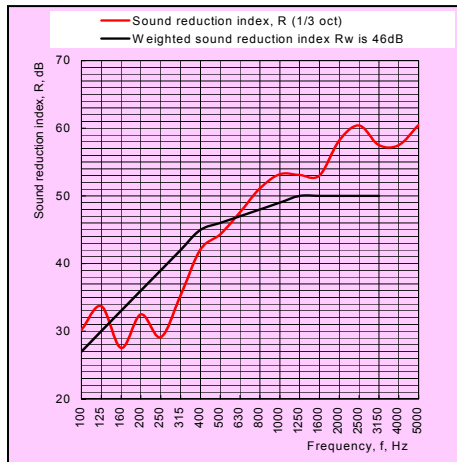

Model: 46dB (STC 44)

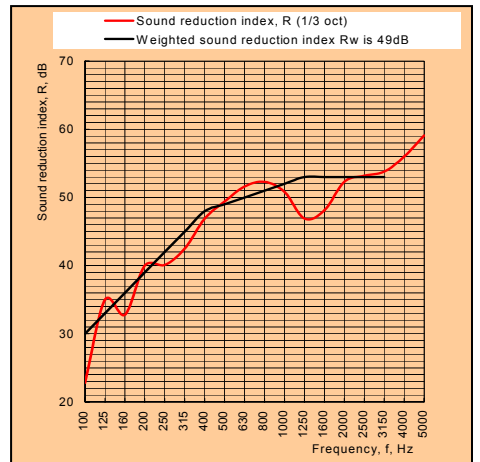

Model: 49dB (STC 50)

**OUTLINE DRAWING OF TYPICAL 41dB-TAF /45dB-TAF**

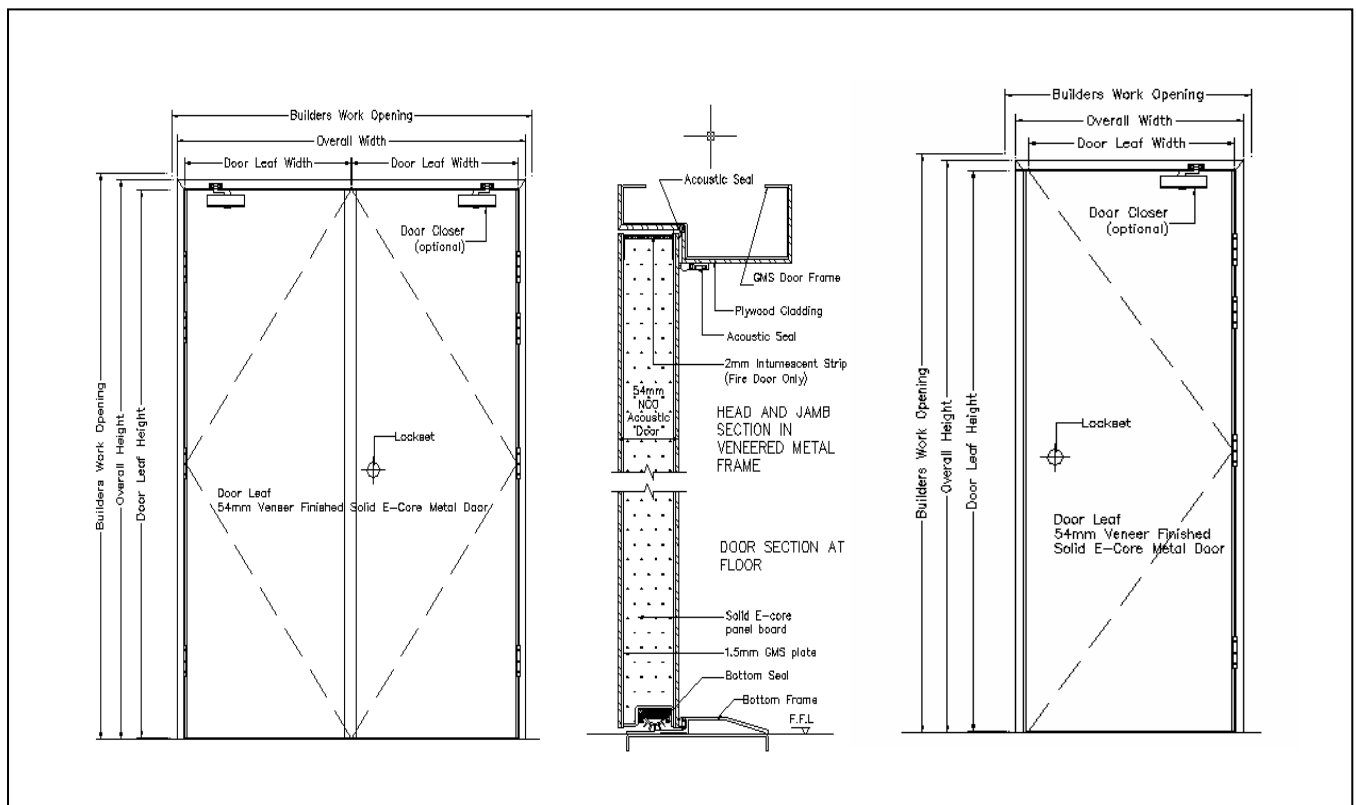

**OUTLINE DRAWING OF TYPICAL 42dB-TAF / 46dB-TAF**

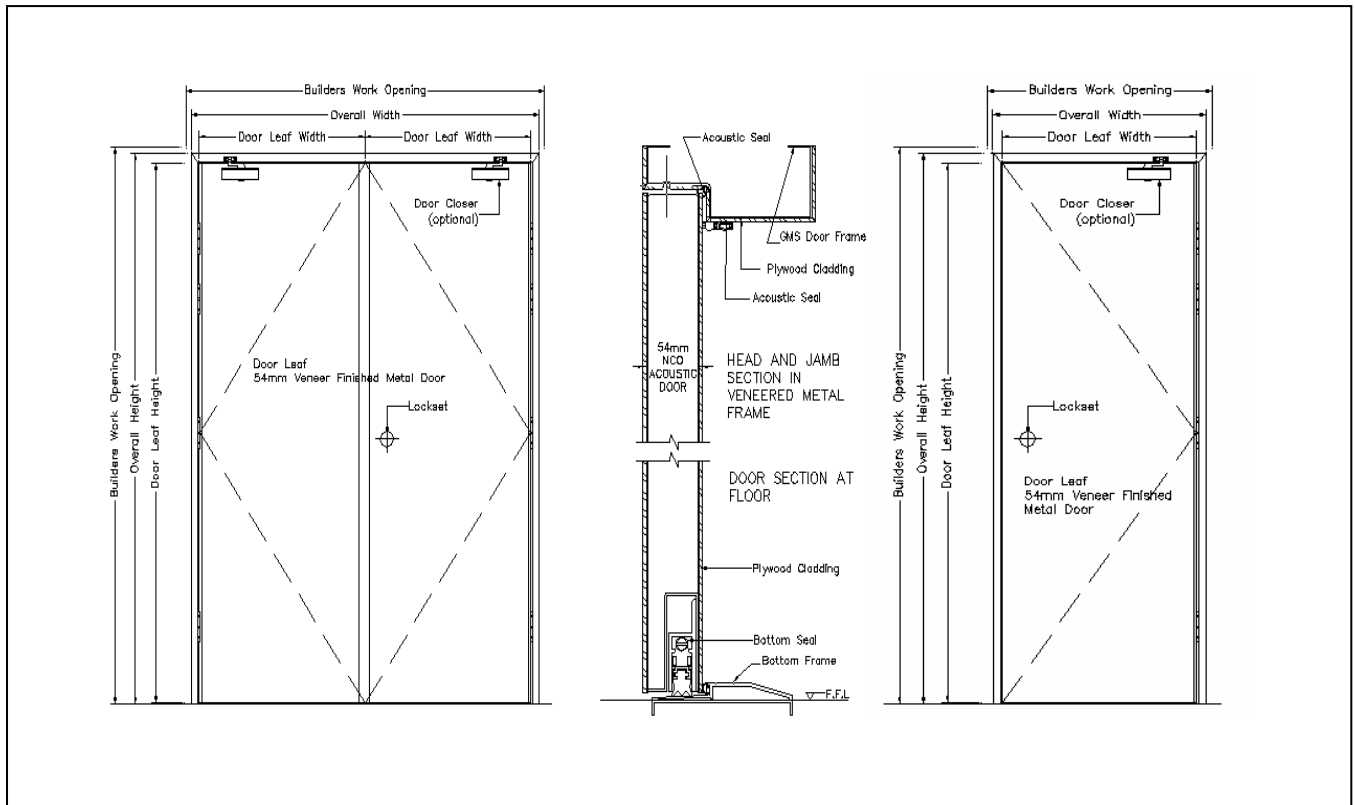

**OUTLINE DRAWING OF TYPICAL 39dB / 43dB-TAF & 40dB / 44dB / 45dB / 49dB-TA**

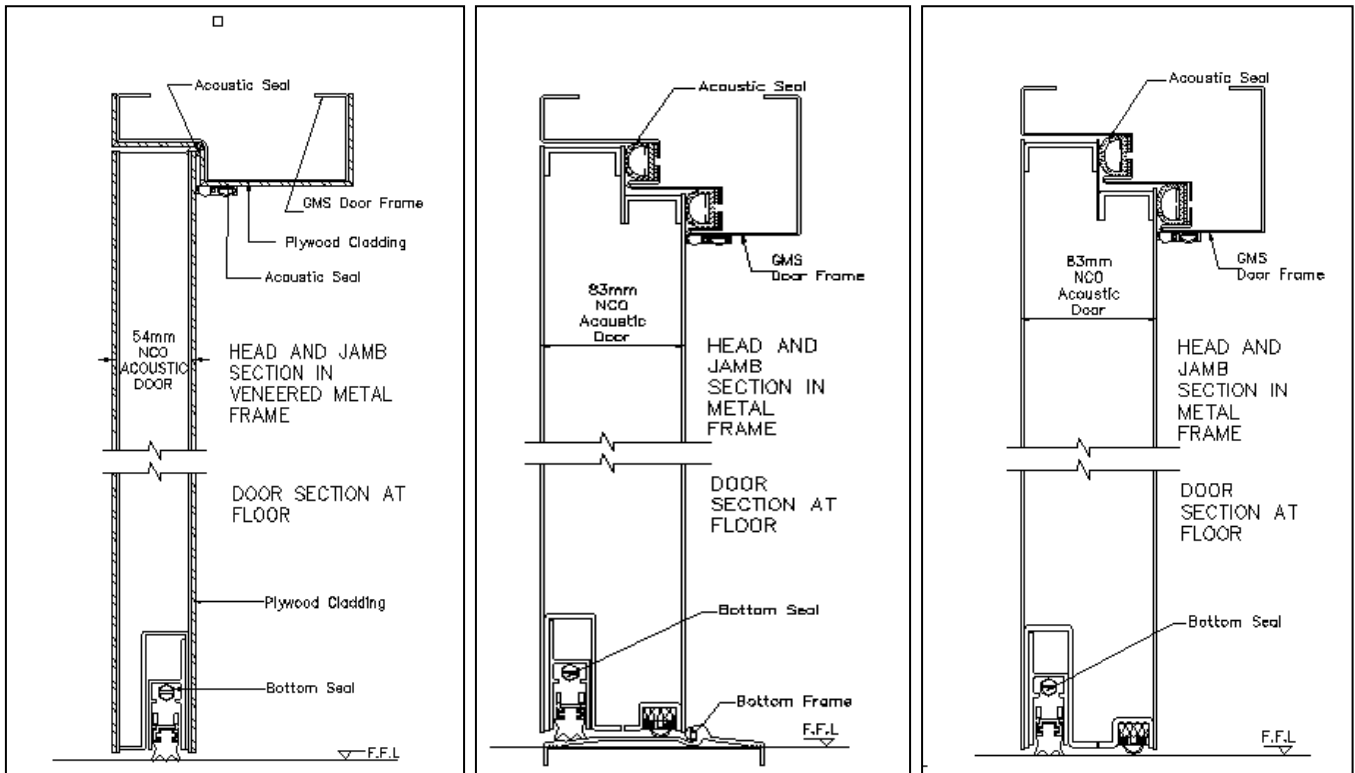

Model: 39dB-TAF / 43dB-TAF

Model: 45dB-TA / 49dB-TA

Model: 40dB-TA / 44dB-TA

OUTLINE DRAWING OF TYPICAL 39dB-TA

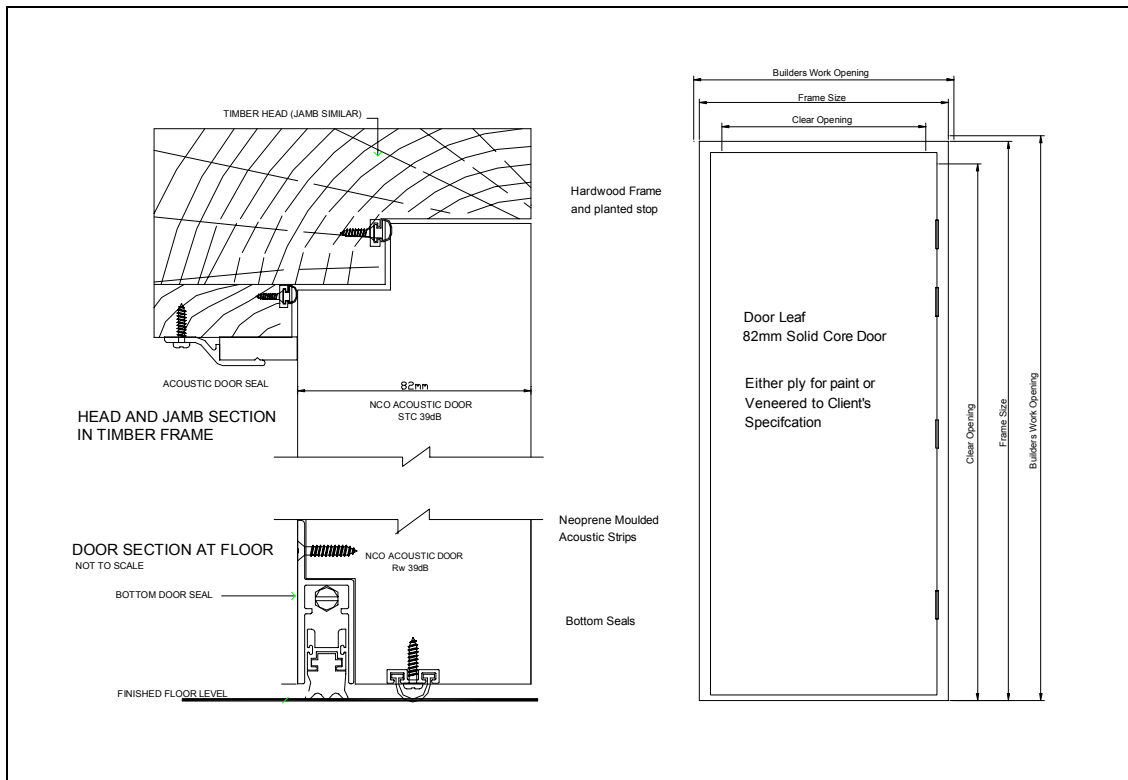

OUTLINE DRAWING OF TYPICAL 37dB-TAF

